



The power to get ahead

DELL USB-C DOCKING SOLUTIONS

Get up and running fast with Dell's most powerful, most compatible and most manageable docks.



Up to 2x

more powerful than the industry standard at 130W*

100%

compatibility with the widest portfolio coverage in the industry*

2x

more manageability features**

Next Generation: Dell USB-C Docking Solutions

USB-C sets a new standard for transmitting data, video, audio and power, and Dell has designed a comprehensive range of USB-C docks to help you enjoy these benefits and work seamlessly with the latest thin and light USB-C laptops, 2-in-1s and workstations.

Dell offers the next generation of USB-C cable docking that utilizes two technologies and capabilities :



USB-C technology

USB-C is a new industry standard, delivering high power and fast transfer speeds. With a symmetrical connector, it is easy to use as it fits into the port in any orientation. Its small connector size and ability to fulfill audio, video, data and even power transfer in a single port means devices built with USB-C now need less ports for the same functions and can be built thinner and lighter.

Thunderbolt technology

Thunderbolt 3 is a superset of capabilities running on USB-C connectors and cables. It is reversible and offers both high speed data and video transfer of up to 40Gbps — that's equivalent to taking just 30 seconds to transfer a 4GB full length movie.

USB-C technology enables:



Single cable connectivity
for video, audio,
data and power



Smaller docks with
flexible mounting options
for a clutter-free desk



Future proofing your docking
solutions with standard USB
Type-C specifications

Powerful. Compatible. Manageable.

Just what you need in a dock



Up to 2x

more powerful than the industry standard at 130W*

Dell Business Docks deliver up to 130W of power, which is double the industry norm. This extra power provided by Dell Business Docks charges your laptop and its attached peripherals much faster than other brands'. Dell ExpressCharge charges up to 80% of your battery within an hour³, so you can move at a moment's notice with plenty of battery backing you up.

- Up to 130W power delivery
- Charges laptops and peripherals faster
- Laptops reach 80% charge in an hour and full charge in two hours



100%

compatible with the widest portfolio coverage in the industry*

With the shift toward USB-C docking as the industry standard, Dell's range of USB-C docks are more compatible than ever. They work with any laptop, 2-in-1 and workstation built to USB-C industry standards. Dell USB-C docks provide the widest portfolio coverage, simplifying IT deployment and management over time. What's more, these docks offer a wide range of connectivity ports allowing you to plug in to a variety of devices.

- Adheres to standard USB-C specifications
- Compatible with 2-in-1s, laptops, workstations
- Diverse connectivity and port options



2x

more manageability features**

Make the most of your Dell USB-C dock when paired with a Dell system by extending your business class features. This includes powerful management and deployment capabilities, like the Dell Command Update (DCU) that automatically checks for the latest BIOS, firmware or required drivers for the dock and PC. Plus, troubleshoot, update, secure and manage devices remotely to save time and improve your operational efficiency.

- Dock support enabled in laptops' BIOS from factory
- Supports Dell Command Update to offer "best known configurations"

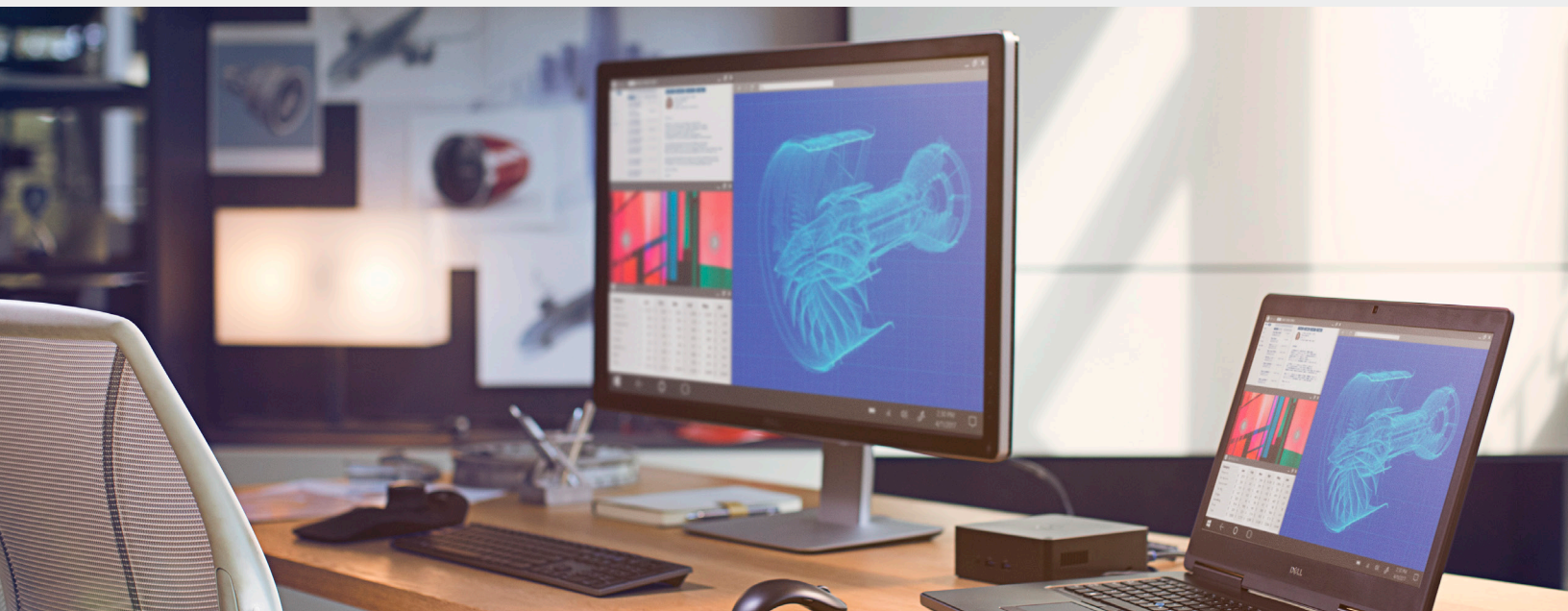

Dell Business Class features



Enjoy these Business Class features when you pair Dell laptops with Dell WD15 and TB16 docks:



PXE Boot – Troubleshoot your PC remotely when connected to the network via network card.



Wake-On-LAN – Starts your PC remotely using the signal over your network.



MAC address pass-through – Recognizes only a unique MAC address entered in the system's BIOS (Basic Input/Output System) by overriding the dock or dongle MAC address every time your laptop is connected to the network, ensuring that your PC's MAC address stays the same no matter which USB-C dock you use.



Port Disablement – Allows ports on the dock to be turned off remotely to keep confidential information secure.



Power Delivery – Single cable offers data, audio, video and power delivery of up to 130W.



Wake-On-Dock button – Allows you to physically power/ turn on the laptop/ tablet by pressing the button.



Wake-On-Dock – Automatically turns on your laptop — that is powered down or on standby — and connects to the peripherals attached when you dock.



Dell Command Update (DCU) – Automatically checks for the latest BIOS, firmware, or drivers required for the dock and PC.



Error messages and dock event notifications – Prompts you to switch to the right wattage when an insufficient power adapter is used with the dock. Also provides notifications for firmware updates and port disablement.

Dell USB-C Docks

The power to get ahead

Whatever your needs, Dell has the right USB-C docking solution for you.

DELL BUSINESS DOCK - WD15



Compatible with a wide range of systems with varied port options and connectivity

- Compatible with a wide range of Dell USB-C laptops, from 2-in-1s to workstations
- Double the charging capability at 130W, enabling 80% of laptop battery charged within an hour with Dell ExpressCharge
- Option for zero footprint with flexible mounting options under desk or behind monitor for a clean desktop
- Diverse connectivity and port options
- Offers Business Class features when used with Dell laptops

DELL BUSINESS THUNDERBOLT DOCK - TB16



Ultimate performance and speedy data transfers for power users connecting to Thunderbolt devices

- Offers lightning-fast data transfers of up to 40Gbps
- Double the charging capability at 130W, enabling 80% of laptop battery charged within an hour with Dell ExpressCharge
- Connects up to three Full HD displays or two 4K displays or one 5K display
- Offers Business Class features when used with Dell laptops

DELL UNIVERSAL DOCK - D6000



Ideal dock for multi-generation hoteling environments requiring USB-C and USB3.0 connectivity, powered by DisplayLink compression technology

- Equipped with both USB-C and USB-A cables for connectivity to legacy or current laptops
- Connects up to three 4K displays[†] or two 4K displays^{††} or one 5K display^{†††}
- Powered by DisplayLink compression technology requiring driver installation
- Supports up to 65W power delivery but does not support Dell ExpressCharge
- Supports MAC address pass-through

[†] Third 4K display at 30Hz. Maximum 3 display output can be supported simultaneously through USB-C connection.

^{††} Maximum 2 display output for USB3.0 (Type-A) connection.

^{†††} 5120 x 2880 (5K) @ 60Hz can be supported with Dual DP1.2 connection / 3840 x 2160 (4K) @ 60Hz can be supported with single DP/HDMI cable connection)

Dell USB-C Docks

The power to get ahead

DELL BUSINESS DOCK - WD15

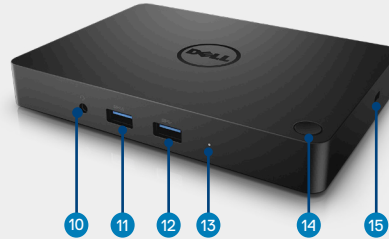
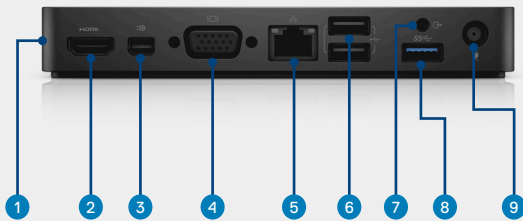

- | | | | |
|---|----------------|-------------------------------|--------------------------|
| 1. Docking station connector | 4. VGA | 9. 7.4 mm DC-in power input | 14. Dock button |
| 2. HDMI | 5. RJ45 GbE | 10. Combo audio/ headset jack | 15. Kensington lock slot |
| 3. Mini-DP (mini-DP to DP cable included) | 6. 2 x USB2.0 | 11. USB 3.0 with Power Share | |
| | 7. Speaker-out | 12. USB 3.0 | |
| | 8. USB 3.0 | 13. Power adapter LED | |

DELL BUSINESS THUNDERBOLT DOCK - TB16



- | | |
|-----------------------------|-------------------------------|
| 1. VGA | 11. Docking station connector |
| 2. HDMI | 12. Combo audio/ headset jack |
| 3. Mini-DP | 13. USB 3.0 w/ PowerShare |
| 4. Full Size DP | 14. USB 3.0 |
| 5. RJ45 GbE | 15. Power adapter LED |
| 6. USB 2.0 (2x) | 16. Dock button |
| 7. USB 3.0 | 17. Kensington lock slot |
| 8. Thunderbolt 3 (USB-C) | |
| 9. 7.4 mm DC-in Power Input | |
| 10. Speaker-out | |

DELL UNIVERSAL DOCK - D6000

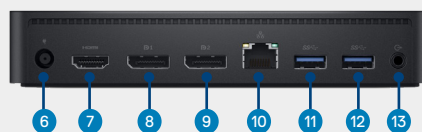
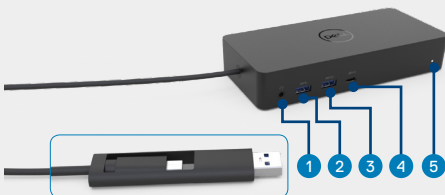

- | | |
|------------------------------|-----------------|
| 1. Combo audio/ headset jack | 7. HDMI |
| 2. USB 3.0 | 8. DP |
| 3. USB 3.0/BC1.2 | 9. DP |
| 4. USB-C/BC1.2 | 10. RJ45 GbE |
| 5. LED indicator | 11. USB 3.0 |
| 6. Power input | 12. USB 3.0 |
| | 13. Speaker-out |

USB-C Docks comparison chart

The power to get ahead



	Dell Business Dock	Dell Business Thunderbolt Dock	Dell Universal Dock ⁶
Model number	WD15	TB16	D6000
Host connector	USB-C	Thunderbolt 3 USB-C	USB-C or USB 3.0
Power delivery to laptop	Up to 130W with ExpressCharge	Up to 130W with ExpressCharge	Up to 65W with USB-C connectivity (No power delivery over USB3.0)
Data	USB 3.1 (5Gbps)	Thunderbolt 3 (40Gbps)	USB 3.1 (5Gbps)
Video (Max. # of displays/resolution of displays²)	Native - DP 1.2 Up to 2 displays: · 1 x 4K ³ · 1 x QHD · 2 x FHD	Thunderbolt 3 Native - DP1.2 Up to 3 displays: · 1 x 5K · 2 x 4K · 3 x FHD	Video Compression (DisplayLink) - DP 1.2 Up to 3 displays: · 1 x 5K · 2 x 4K · 3 x 4K ⁴
Mounting options (Optional Dell Docking Station Mounting Kit sold separately)	· Under desk · Behind monitor	· Under desk · Behind monitor	· None
Ports			
DisplayPort	-	1	2
Mini-DisplayPort	1	1	-
HDMI	1	1	1
VGA	1	1	-
USB3.0	3	3	4
USB2.0	2	2	-
Thunderbolt 3	-	1	-
RJ45 GbE	1	1	1
Combo audio in/out	1	1	1
Speaker out	1	1	1
Graphics	Native graphics - no driver required	Native graphics - no driver required	USB graphics - DisplayLink driver required
Business class features	<ul style="list-style-type: none"> · PXE Boot · MAC address pass-through · Wake-On-LAN · Wake-On-Dock · Dell Command Firmware update · Port disablement · Error messages and notifications 	<ul style="list-style-type: none"> · PXE Boot · MAC address pass-through · Wake-On-LAN · Wake-On-Dock · Dell Command Firmware update · Port disablement · Error messages and notifications 	<ul style="list-style-type: none"> · MAC address pass-through · DisplayLink software interface
Platform Compatibility⁵	Precision/Latitude/XPS	Precision/XPS/Latitude	PC with DisplayLink driver installation

¹ Business class features like PXE Boot, MAC address pass through, Wake-On-LAN, Dell Command Update and Port disablement are offered to all Dell USB-C docks, except for the Dell Universal Dock D6000.

² 5K resolution = 5120 x 2880, 4K resolution = 3840 x 2160, FHD resolution = 1920 x 1080.

³ 4K resolution display at 30Hz.

⁴ Third 4K resolution display at 30Hz.

⁵ Dell follows the standard USB-C protocol. Full functionality with competitors' USB-C platforms may vary. Please refer to compatibility charts in Appendix.

⁶ Does not support business class features. For laptops requiring more than 65W of power, please also plug in your laptop power adapter.

*Based on Dell internal analysis of competitive products using publicly available information as of November 2017.

**Based on Dell internal analysis comparing to the Lenovo Thinkpad dock, December 2017

For more information, visit dell.com/docking or contact your Dell representative. Product availability varies by country.

Copyright © 2018 Dell Inc.

Appendix

Dell USB-C Docking compatibility matrix

Docking Support

Platform		Dell Business Dock - WD15	Dell Business Thunderbolt Dock - TB16	Dell Universal Dock - D6000
Latitude	Latitude 3390 2in1	✓	✗	✓
	Latitude 3490	✓	✗	✓
	Latitude 3590	✓	✗	✓
	Latitude 5175/5179	✓	✗	✓
	Latitude 5280	✓	✗	✓
	Latitude 5285	✓	✗	✓
	Latitude 5289	✓	✗	✓
	Latitude 5290	✓	✗	✓
	Latitude 5290 2in1	✓	✓	✓
	Latitude 5389	✓	✗	✓
	Latitude 5480 H Discrete	✓	✓	✓
	Latitude 5480 U or H UMA	✓	✗	✓
	Latitude 5490	✓	✗	✓
	Latitude 5495	✓	✗	✓
	Latitude 5580 H Discrete	✓	✓	✓
	Latitude 5580 U or H UMA	✓	✗	✓
	Latitude 5590	✓	✗	✓
	Latitude 7275	✓	✓	✓
	Latitude 7280	✓	✓	✓
	Latitude 7290	✓	✓	✓
	Latitude 7285	✓	✓	✓
	Latitude 7370	✓	✓	✓
	Latitude 7380	✓	✓	✓
	Latitude 7389	✓	✗	✓
	Latitude 7390	✓	✓	✓
	Latitude 7390 2in1	✓	✓	✓
	Latitude 7480	✓	✓	✓
	Latitude 7490	✓	✓	✓
	Latitude E5570 H Discrete	✓	✓	✗

Appendix

Dell USB-C Docking compatibility matrix

Docking Support

Platform		Dell Business Dock - WD15	Dell Business Thunderbolt Dock - TB16	Dell Universal Dock - D6000
Precision	Precision 3510 UMA	✓	✗	✗
	Precision 3510 H Discrete	✓	✓	✗
	Precision 3520 H UMA	✓	✗	✗
	Precision 3520 H Discrete	✓	✓	✗
	Precision 5510	✓	✓	✗
	Precision 5520	✓	✓	✗
	Precision 7510*	✓	✓	✗
	Precision 7520*	✓	✓	✗
	Precision 7710*	✓	✓	✗
	Precision 7720*	✓	✓	✗
XPS	XPS 12 9250	✓	✓	✓
	XPS 13 2-in-1 9365	✓	✓	✓
	XPS 13 9350	✓	✓	✓
	XPS 13 9360	✓	✓	✓
	XPS 13 9370	✓	✓	✓
	XPS 15 9550	✓	✓	✓
	XPS 15 9560	✓	✓	✓
	Vostro 5370	✗	✗	✓
	Vostro 5471	✗	✗	✓

*Precision 7510/ 7520/7710/ 7720 require the workstation power adapter for charging, as these systems require more power than 130W.

Compatibility matrix is subject to change.

Appendix

Adapter compatibility chart

Dell Business Dock - WD15

Platform	130W	180W	Platform	130W	180W
Latitude 3390 2in1	•	△	Latitude 7380	•	△
Latitude 3490	•	△	Latitude 7389	•	△
Latitude 3590	•	△	Latitude 7390	•	△
Latitude 5175/5179	•	△	Latitude 7390 2in1	•	△
Latitude 5280	•	△	Latitude 7480	•	△
Latitude 5285	•	△	Latitude 7490	•	△
Latitude 5289	•	△	Latitude E5570 H Discrete	-	•
Latitude 5290	•	△	Precision 3510	-	•
Latitude 5290 2in1	•	△	Precision 3520	-	•
Latitude 5389	•	△	Precision 5510	-	•
Latitude 5480 H Discrete	•	△	Precision 5520	-	•
Latitude 5480 U or H UMA	•	△	Precision 7510*	-	•
Latitude 5490	•	△	Precision 7520*	-	•
Latitude 5495	•	△	Precision 7710*	-	•
Latitude 5580 H Discrete	•	△	Precision 7720*	-	•
Latitude 5580 U or H UMA	•	△	XPS 12 9250	•	△
Latitude 5590	•	△	XPS 13 2-in-1 9365	•	△
Latitude 7275	•	△	XPS 13 9350	•	△
Latitude 7280	•	△	XPS 13 9360	•	△
Latitude 7285	•	△	XPS 13 9370	•	△
Latitude 7290	•	△	XPS 15 9550	-	•
Latitude 7370	•	△	XPS 15 9560	-	•

Dell Business Thunderbolt Dock - TB16

Platform	180W	240W
Latitude 5290 2in1	•	△
Latitude 5480 H Discrete	•	△
Latitude 5580 H Discrete	•	△
Latitude 7275	•	△
Latitude 7280	•	△
Latitude 7285	•	△
Latitude 7290	•	△
Latitude 7370	•	△
Latitude 7380	•	△
Latitude 7390	•	△
Latitude 7390 2in1	•	△
Latitude 7389	•	△
Latitude 7480	•	△
Latitude 7490	•	△
Latitude E5570 H Discrete	•	△
Precision 3510	•	•
Precision 3520	-	•
Precision 5510	-	•
Precision 5520	-	•
Precision 7510*	-	•
Precision 7520*	-	•
Precision 7710*	-	•
Precision 7720*	-	•
XPS 12 9250	•	△
XPS 13 2-in-1 9365	•	△
XPS 13 9350	•	△
XPS 13 9360	•	△
XPS 13 9370	•	△
XPS 15 9550	-	•
XPS 15 9560	-	•

- Recommended
- △ Supported
- Not recommended

*Precision 7510/ 7520/7710/ 7720 require the workstation power adapter for charging, as these systems require more power than 130W.
Power adapter compatibility chart is a subject to change.

For more information, visit dell.com/docking or contact your Dell representative. Product availability varies by country.
Copyright © 2018 Dell Inc.